



SICKLE BAR ASSEMBLY

Service Parts Breakdown

No. L-142
**SPEEDEX TRACTOR
COMPANY**
RAVENNA, OHIO 44266

Division of
Mechtron International Corp.

From www.speedtractors.com

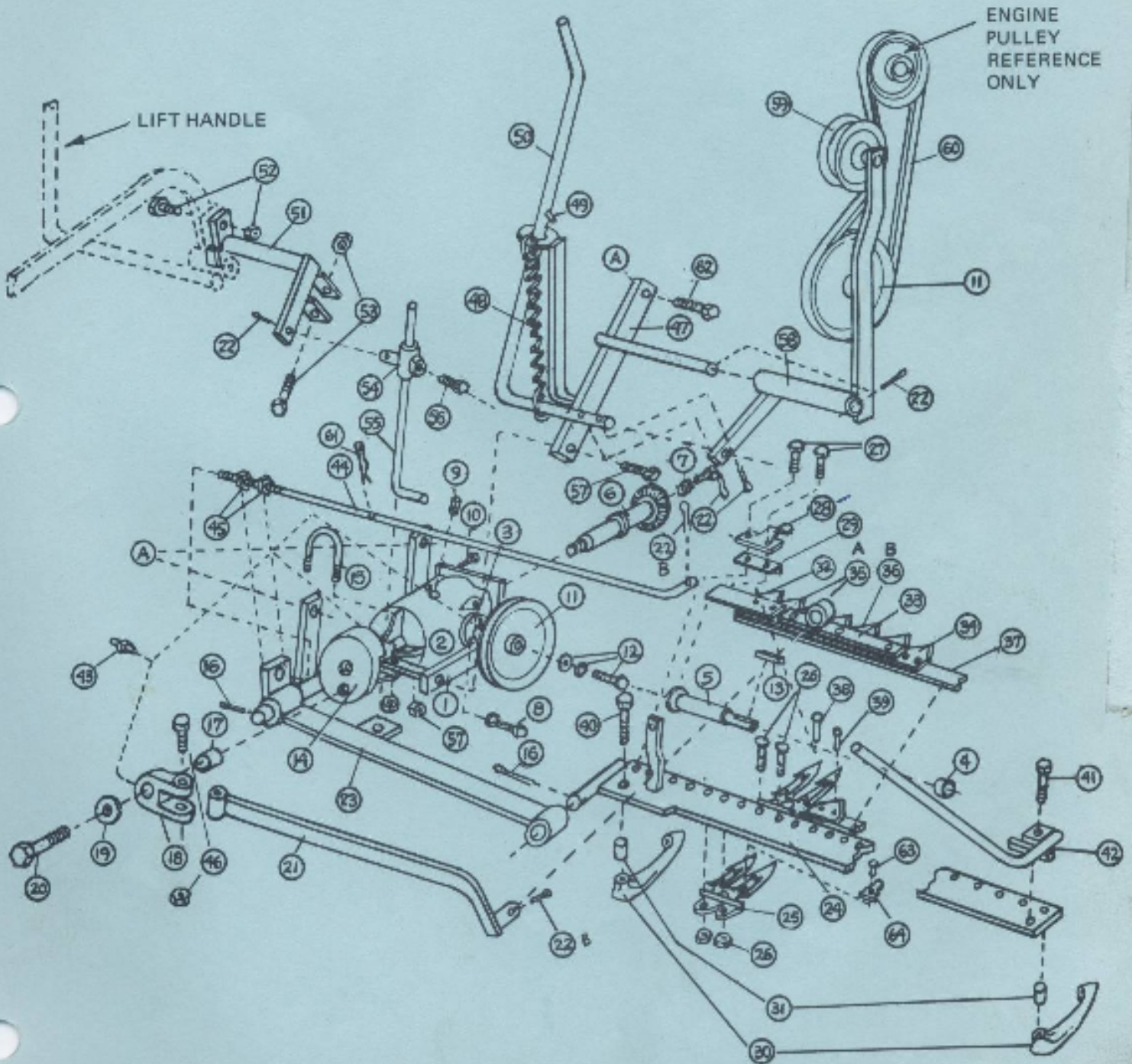



SPEEDEX TRACTOR COMPANY

DIVISION OF
MECHTRON INTERNATIONAL CORPORATION

367 North Freedom Street
Ravenna, Ohio 44266

From www.speedextractors.com

Telephone (216) 296-8137
(216) 297-1484

42" SICKLE BAR, No. L-142

Item	Code Number	Description
1.	142-7001	Frame Weldment
2.	142-0701	Gear Box Housing
3.	142-7002	Input Housing (Shaft)
4.	40-1117	Insert Bronze Bushing
5.	142-7003	Input Gear Assembly
6.	142-7004	Output Gear Assembly
7.	847-3004	Adjusting Screw 3/18-16 x 1"
	904-3000	Full Hex Nut 3/8-16
8.	847-2803	Mounting Screw 5/16-18 x 3/4"
	80-0528	Medium Lockwasher 5/16
9.	866-7100	Pipe Plug 1/4"
10.	847-2804	Mounting Screw 5/16-18 x 1"
	80-0528	Medium Lockwasher 5/16
11.	372-1360	Input Pulley 6" OD x 13/16 Bore
12.	847-2803	Screw 5/16-18 x 3/4
	80-0528	Medium Lockwasher 5/16
	80-0226	Wrot Washer 3/8
13.	68-0316	Flat Key 3/16 x 1"
14.	142-0702	Counterweight Output
15.	897-0430	"U" Clamp
	80-0530	Medium Lockwasher 3/8
	902-3000	Full Hex Nut 3/8-16
16.	52-0416	Cotter Key 3/16 x 2"
17.	40-8351	Knuckle Bushing 1"
18.	142-8005	Knuckle Complete w/bushing/screw & nut
19.	40-5625	Flinger
20.	818-3805	Pitman Shoulder Screw 5/8-18
21.	142-7005	Pitman Arm
22.	52-0206	Cotter Pin 3/16 x 2"
23.	142-7006	Carriage Arm
24.	142-8002	Knife Carriage
25.	142-9001	Dual Guard w/ledger plates
26.	851-3205	Plow Bolt w/nuts 7/16-14 x 1 1/4"
27.	851-3204	Plow Bolt w/nuts 7/16-14 x 1"
28.	142-9002	Hold Down Finger
29.	142-9003	Wear Plate
30.	142-0703	Skid
31.	432-4001	Spacer 3/4"
32.	142-2009	Guide Plate
33.	142-7012	Drive Plate
34.	142-0104	Knife Std. Section - 18 Required - MS10004

ALL PRICES F.O.B., RAVENNA, OHIO — ALL PRICES ARE SUBJECT TO CHANGE WITHOUT NOTICE



SPEEDEX TRACTOR COMPANY

DIVISION OF
MECHTRON INTERNATIONAL CORPORATION

367 North Freedom Street
Ravenna, Ohio 44266

From www.speedextractors.com

Telephone (216) 296-8137
(216) 297-1484

42" SICKLE BAR, No. L-142

Page 2

Item	Code Number	Description
35.	142-0107	Knife Spec. Section "A" - 2 Required - MS10007
36.	142-0106	Knife Spec. Section "B" - 1 Required - MS10006
37.	142-8003	Knife Bar Complete
38.	50-0310	Rivet "Long" 3/16 x 5/8"
39.	50-0308	Rivet "Short" 3/16 x 1/2"
40.	846-3007	Skid Screw 3/8-16 x 1 3/4"
41.	846-3006	Skid Screw 3/8-16 x 2"
42.	142-7008	Swath Bar Assembly
43.	862-0501	Grease Fitting
44.	142-1501	Leveling Rod
45.	902-3300	Leveling Rod Nuts 7/16-20
46.	847-3311	Knuckle Screw 7/16-20 x 2 3/4
	902-3300	Full Hex Nut 7/16-20
47.	142-7009	Clutch Arm Mount Support
48.	343-0820	Clutch Spring
49.	444-1005	Pin
50.	142-1502	Clutch Handle
51.	142-7010	Lift Saddle
52.	845-3006	Screw 3/8-16 x 1 1/2"
	919-3000	Locknut 3/8-16
53.	847-2807	Lock Screw 5/16-18 x 1 3/4"
	919-2800	Locknut 5/16-18
54.	1906-8001	Knuckle w/849-3003 Screw
55.	142-1503	Lift Rod
56.	849-3003	Lock Screw 3/8-16 x 3/4
57.	846-3007	Screw 3/8-16 x 1 3/4"
	919-3000	Locknut 3/8-16
58.	142-7011	Clutch Arm Assembly
59.	380-1032	Flat Idler Pulley 3 1/4 OD x 5/8 Bore
60.	392-3480	Drive Belt - S-24 Only (48")
	392-3440	Drive Belt - S-17 - S-19 Only (44")
61.	54-0009	Hair Pin #9
62.	846-3006	Screws 3/8-16 x 1 1/2
	919-3000	Locknut 3/8-16
63.	50-1316	Rivet Ledger 3/16 x 1"
64.	142-9004	Ledger Plate