

# **STRONGLAND™**

## **66" MOWER DECK**

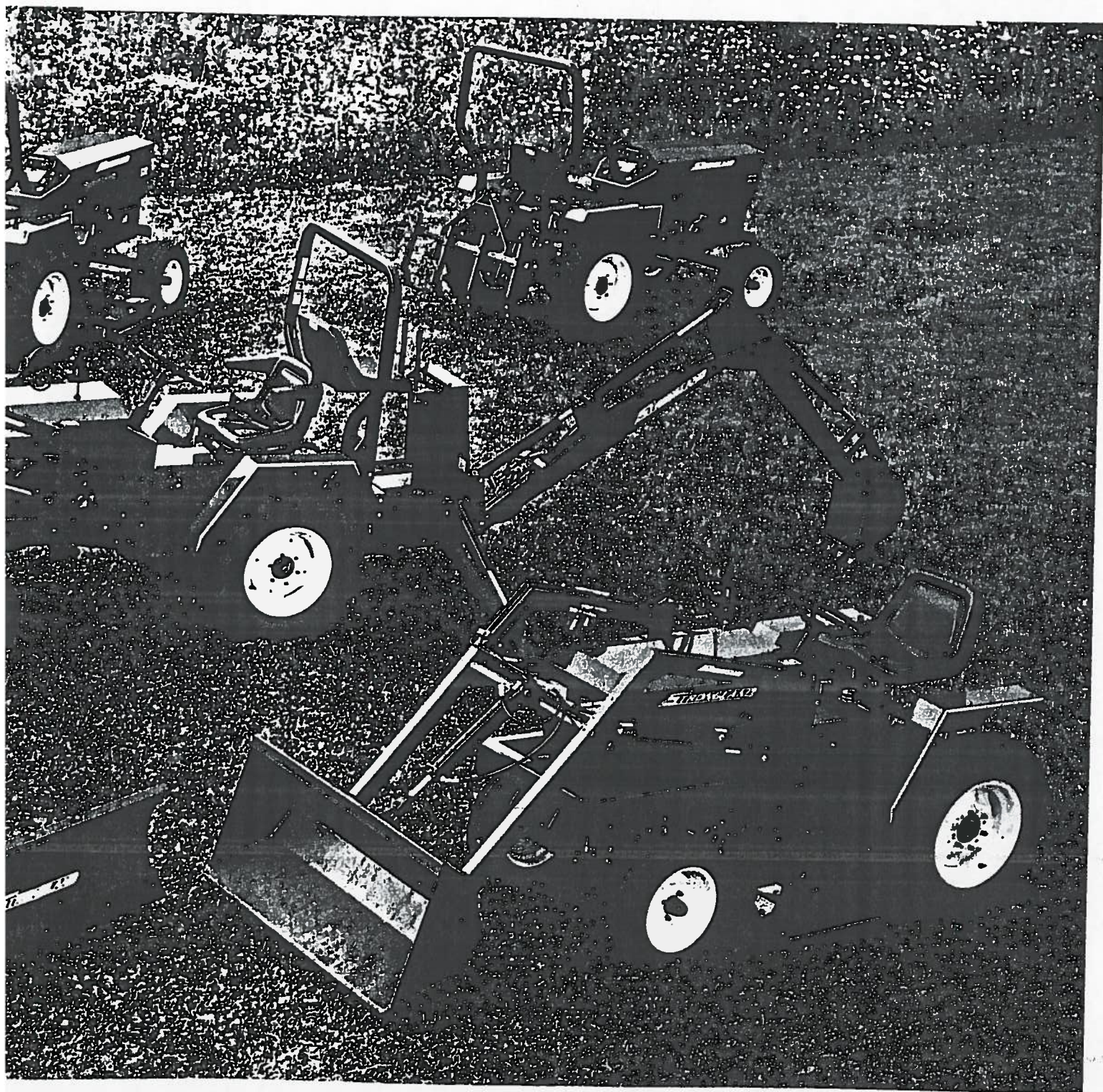

## 66" MOWER DECK ASSEMBLY

REFERENCE	QUANTITY	PART NUMBER	PART DESCRIPTION
A	1	204000	66" Mower Deck Assembly
1	1	204001	66" Mower Deck Weldment
2	1	2005GE	L.H. Gear Box (BC)
3	1	2005GD	Center Gear Box (DE)
4	1	2005GF	R.H. Gear Box (FG)
5	1	2045BA	R.H. (Pulley) Side Mower Shaft
6	4	2005BA	Splined Coupling
7	4	2005ZF	E-Clip
8	1	2005PM	Mower Pulley
9	1	2025AA	Pillow Block
10	3	2005ZC	Shield Cup
11	3	2005ZE	Shear Block
12	6	2005ZP	Shear Pin
13	3	2000AA	Mower Blade Retaining Bolt 5/8-UNF x 1 1/4 Grade 5
14	3	2025VJ	22" Mower Blade
15	3	2005ZD	Shear Block Assembly
16	1	204930	Mower Chute 66" Deck
17	1	203026	Mower Chute Hinge
18	1	203027	Hinge Pin
19	2	2000AB	Mower Chute Spring
20	1	N/A	3/16" Square Key
21	8	200001	Mower Roller
22	3	200920	Wheel Rack Weldment
23	2	200721	L.H. Wheel Rack Bracket
24	1	200722	R.H. Wheel Rack Bracket
25	1	204710	Height Adjust Pivot Shaft
26	1	203030	Height Adjust Sector
27	1	203003	Height Adjust Handle
28	1	N/A	Rubber Handle
29	2	2045BB	L. H. Mower Shaft
30	2	204730	Front Anti-Scalp Roller Spindle
31	2	204737	Front Anti-Scalp Roller Shaft
32	2	204731	Front Anti-Scalp Roller Bracket

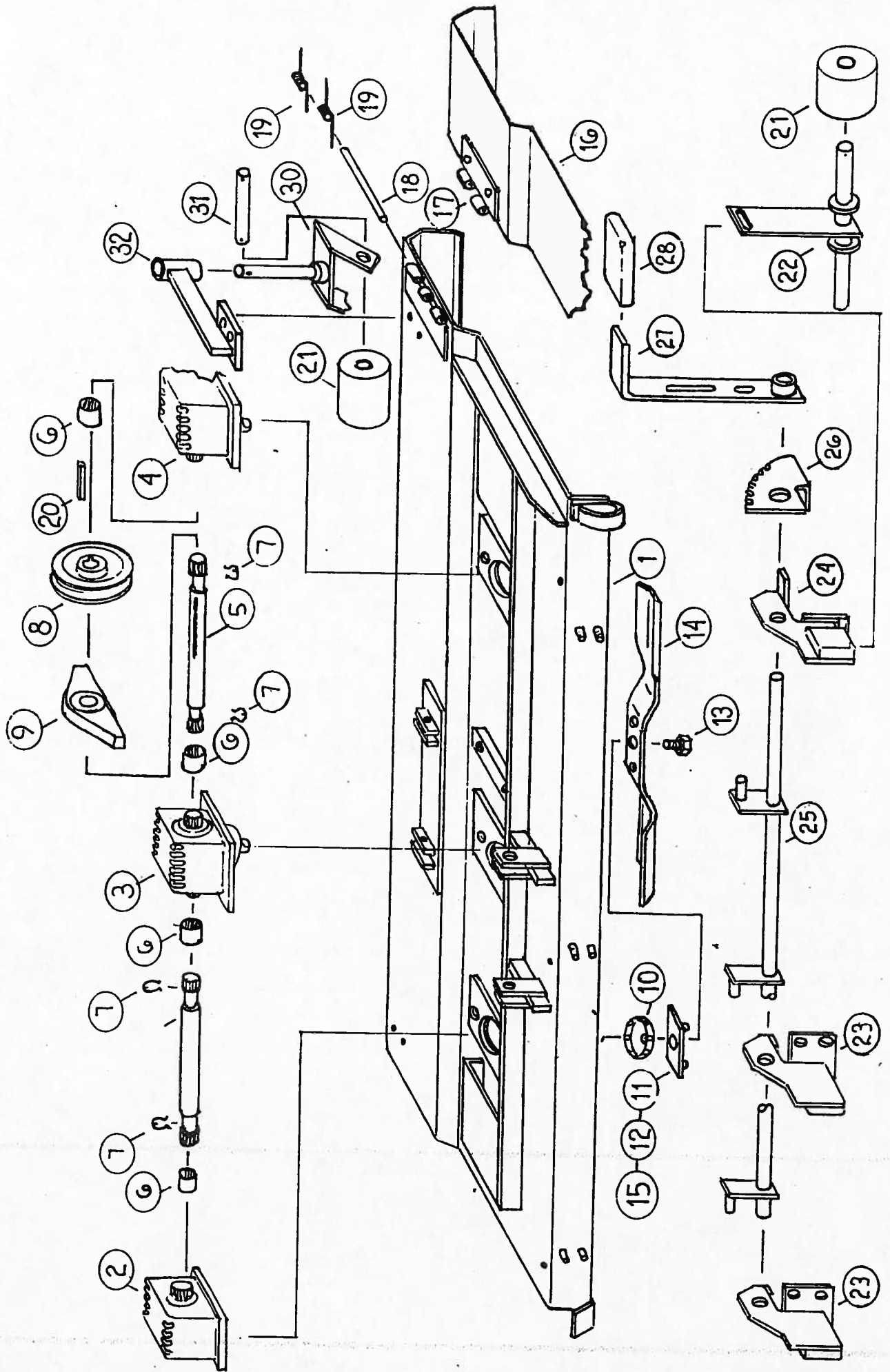

# GEAR BOX LOCATION CHART

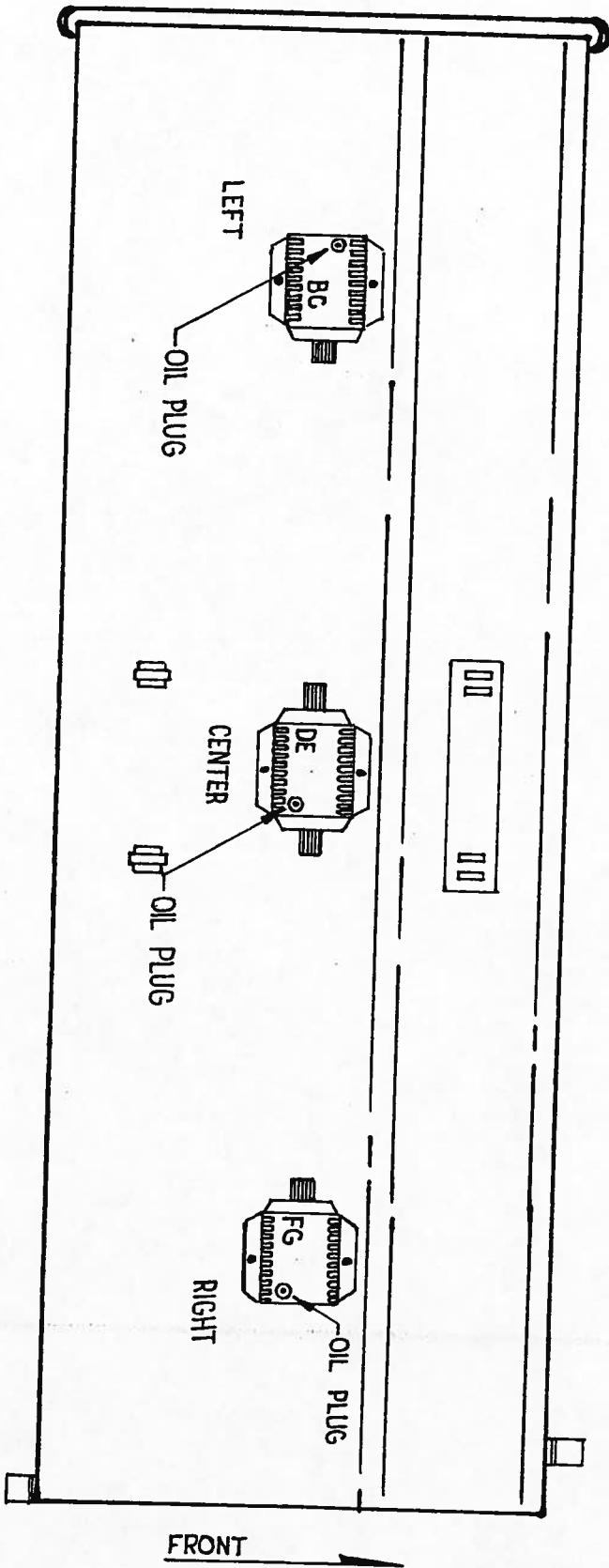

**NOTE:** BOXES WILL BE SENT WITH LUBRICATING OIL FILLED  
BLADE MOUNTING BOLTS ARE TORQUED TO 45 ft-lbs.

